

FOR SALE - 31,872 SF Office/Whse
FOR LEASE - 21,872 SF Office/Whse

2282-2298 Grissom Dr, Maryland Heights MO 63043

**NEW
PRICING**

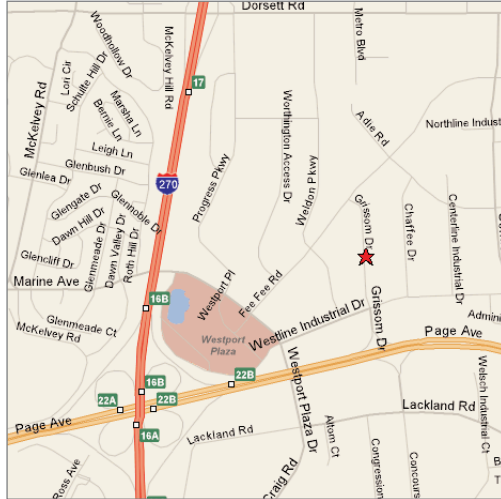

Property Highlights

For Sale:

- 31,872 SF building
- 21,872 SF available for user / tenant
- Fully sprinklered
- Bank financing available to qualified buyer

For Lease:

- 21,872 SF available
- 18,000 SF fully air conditioned office includes showroom, 2 conference rooms, large break room & maintenance shop
- 8,000 SF warehouse has 18' clear ceilings, 1 dock & 1 over sized drive-in

Sale Price / Lease Rate
\$1,750,000 / \$5.00 psf, NNN
\$1.25+/- NNN

Contact

Floyd L. Sweeney, SIOR, MCR
314 994 4445
fsweeney@naidesco.com

Lin Sweazy
314 994 4448
lsweazy@naidesco.com

NAIDESCO
Commercial Real Estate Services, Worldwide.

The information contained herein has been given to us by the owner of the property or other sources we deem reliable. We have no reason to doubt its accuracy, but we do not guarantee it. All information should be verified prior to lease or purchase.

FLOOR PLAN

2282-2298 Grissom Dr, Maryland Heights MO 63043

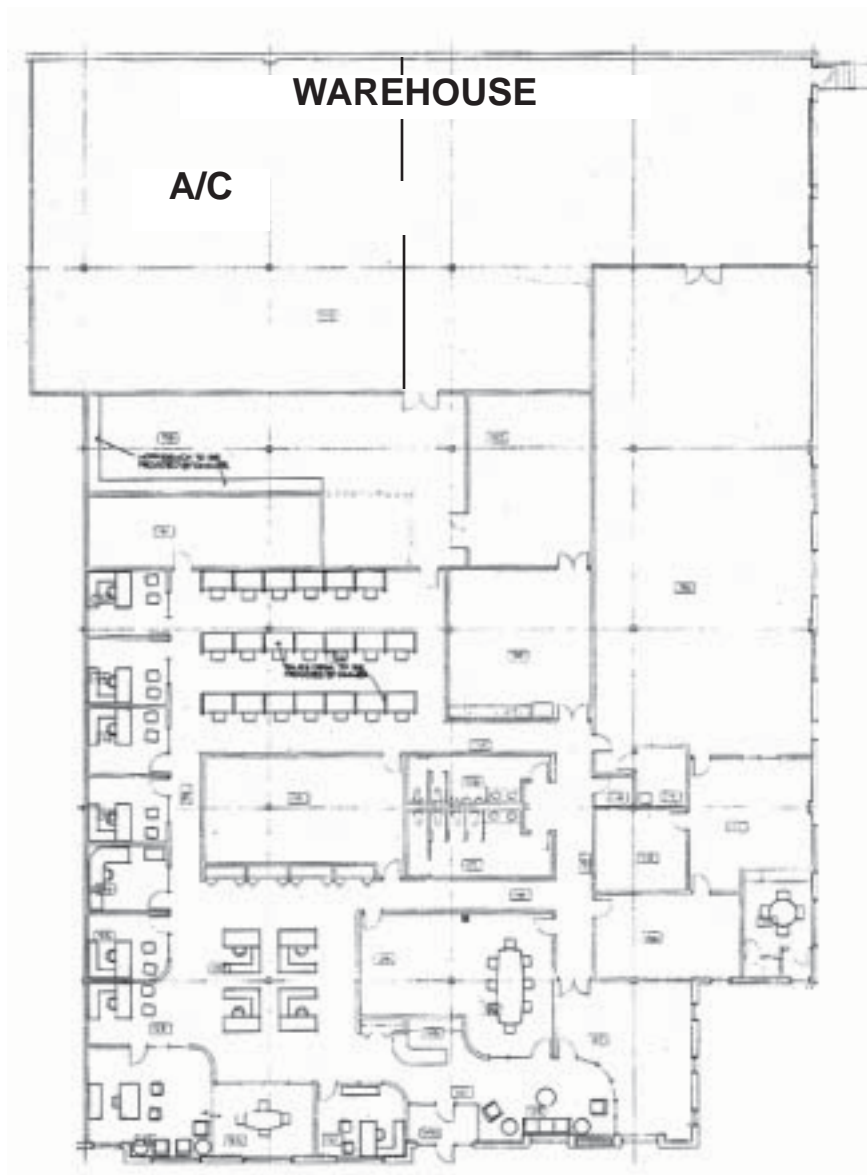

Contact



Commercial Real Estate Services, Worldwide.

Floyd L. Sweeney, SIOR, MCR
314 994 4445
fsweeney@naidesco.com

Lin Sweazy
314 994 4448
lsweazy@naidesco.com

The information contained herein has been given to us by the owner of the property or other sources we deem reliable. We have no reason to doubt its accuracy, but we do not guarantee it. All information should be verified prior to lease or purchase.

8235 Forsyth Blvd Ste 210 St Louis MO 63105
Phone 314 994 4444 Fax 314 994 4088
www.naidesco.com