

SPIRIT VALLEY BUSINESS PARK 2.17 Acre Industrial Lot for Sale

612 Spirit Valley East Dr Lot #10, Chesterfield (Valley) MO 63005

Outside
Storage
Permitted

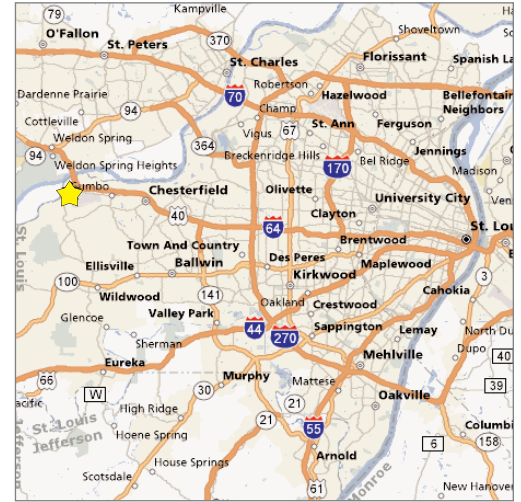

Property Highlights

- Spirit Valley Business Park is located in the west end of Chesterfield Valley across from Rombach pumpkin farm
- 2.17 acre industrial lot available
- Office/warehouse or light manufacturing use
- Screened outside storage permitted
- Great access to I-64/Hwy 40; Olive Street Rd changes to Route 109 as you head south
- Additional 2.0-4.5 acre lots available

Sale Price

\$656,950 (\$6.95 psf)

Land leases and build-to-suit available, contact broker for pricing



Commercial Real Estate Services, Worldwide.

Contact

Daniel W. Hayes
314 994 4068 Direct
314 401 4944 Mobile
dhayes@naidesco.com

The information contained herein has been given to us by the owner of the property or other sources we deem reliable. We have no reason to doubt its accuracy, but we do not guarantee it. All information should be verified prior to lease or purchase.

8235 Forsyth Blvd Ste 210 St Louis MO 63105
Phone 314 994 4444 Fax 314 994 4088
www.naidesco.com

SPIRIT VALLEY BUSINESS PARK

612 Spirit Valley East Dr Lot #10, Chesterfield (Valley) MO 63005



Conceptual Site Plan

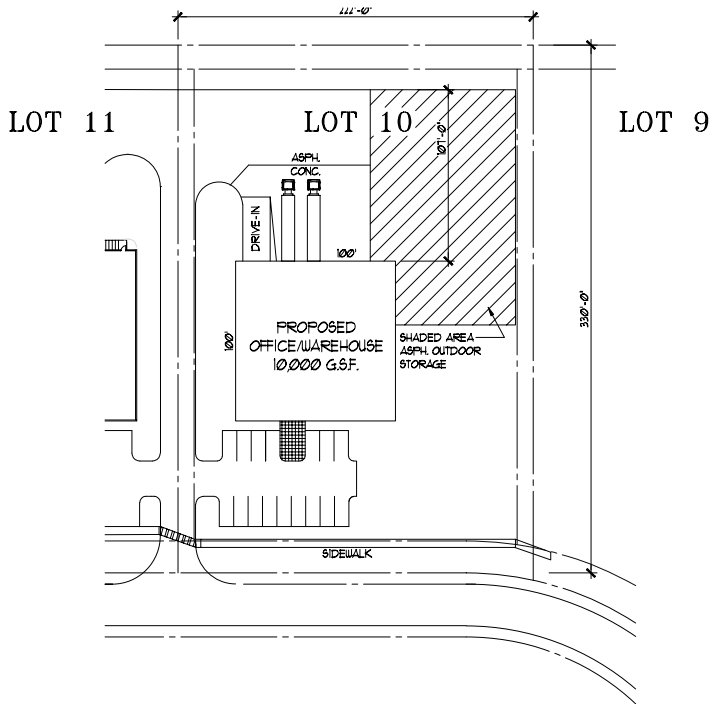

Contact

Daniel W. Hayes
314 994 4068 Direct
314 401 4944 Mobile
dhayes@naidesco.com

NAIDESCO
Commercial Real Estate Services, Worldwide.

8235 Forsyth Blvd Ste 210 St Louis MO 63105
Phone 314 994 4444 Fax 314 994 4088
www.naidesco.com

The information contained herein has been given to us by the owner of the property or other sources we deem reliable. We have no reason to doubt its accuracy, but we do not guarantee it. All information should be verified prior to lease or purchase.