

FOR LEASE

21,840-45,269 SF Office / Warehouse

2345 - 2349 Chaffee Dr, Maryland Heights MO 63146



2345 Property Highlights

- 23,429 SF office/warehouse
- 2,129 SF office
- 20' ceilings
- 4 docks & 1 drive-in door
- Fully wet sprinklered
- 32' x 35' column spacing
- Ample parking
- West Port amenities nearby

Lease Rate \$3.75 psf, NNN

2349 Property Highlights

- 21,840 SF office/warehouse
- 11,102 SF office (can be reduced)
- 20' ceilings
- 2 docks
- Fully wet sprinklered
- 3 phase electric
- 32' x 35' column spacing
- Ample parking

Lease Rate \$3.75 psf, NNN



Commercial Real Estate Services, Worldwide.

Contact

John J. Sheahan, Jr., SIOR
314 994 4176 Direct
314 402 1031 Mobile
jsheahan@naidesco.com

8235 Forsyth Blvd Ste 210 | St Louis MO 63105
Phone 314 994 4444 | Fax 314 994 4088
www.naidesco.com | info@naidesco.com

The information contained herein has been given to us by the owner of the property or other sources we deem reliable. We have no reason to doubt its accuracy, but we do not guarantee it. All information should be verified prior to lease or purchase.

FLOOR PLAN

2345 - 2349 Chaffee Dr, Maryland Heights MO 63146

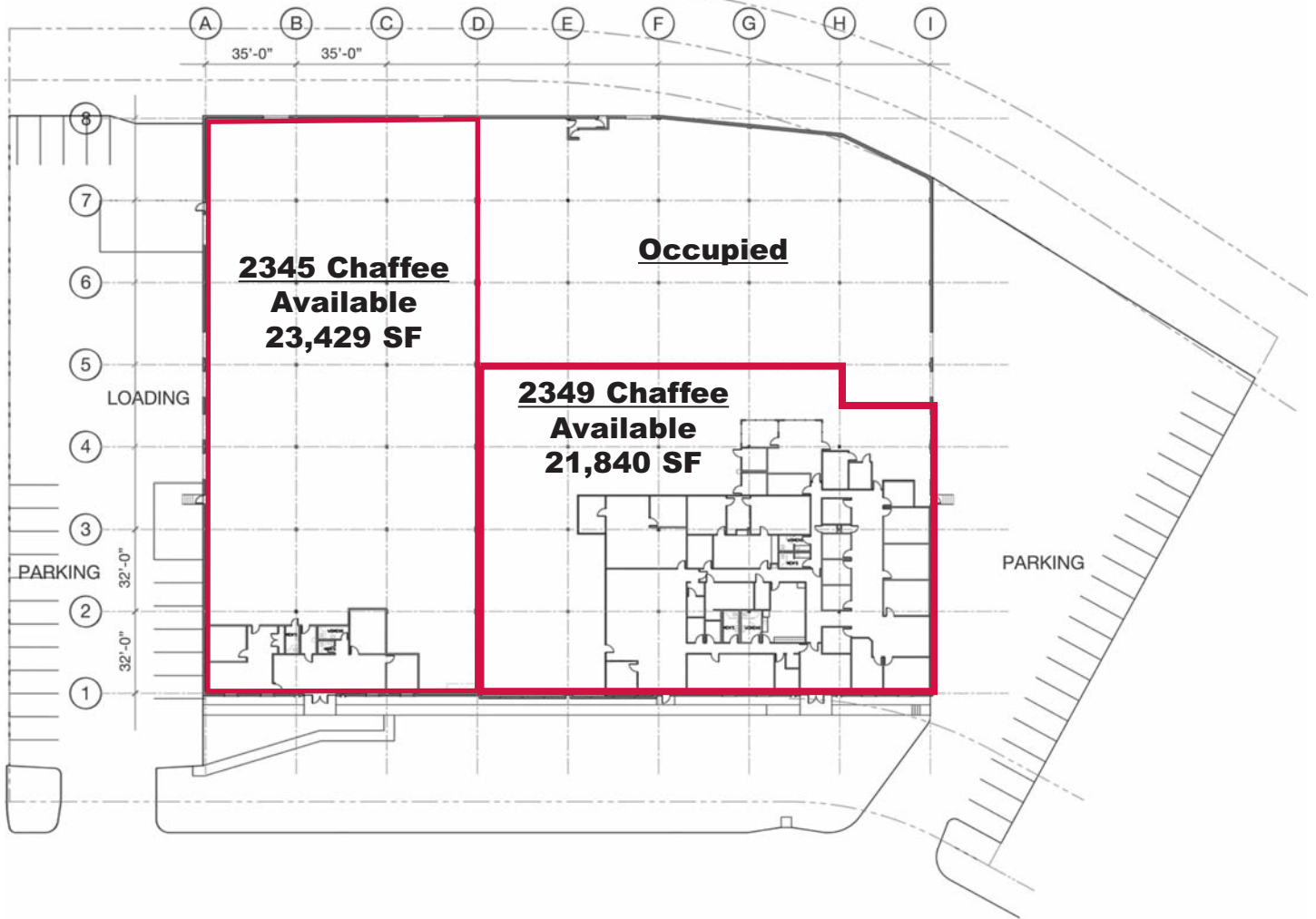

NAIDESCO
Commercial Real Estate Services, Worldwide.

Contact

John J. Sheahan, Jr., SIOR
314 994 4176 Direct
314 402 1031 Mobile
jsheahan@naidesco.com

The information contained herein has been given to us by the owner of the property or other sources we deem reliable. We have no reason to doubt its accuracy, but we do not guarantee it. All information should be verified prior to lease or purchase.

8235 Forsyth Blvd Ste 210 | St Louis MO 63105
Phone 314 994 4444 | Fax 314 994 4088
www.naidesco.com | info@naidesco.com