

FOR SALE
51,696 SF Retail/Showroom/Office/Whse
 14290 Manchester Rd, Manchester MO 63011

**New
 Sale
 Price**

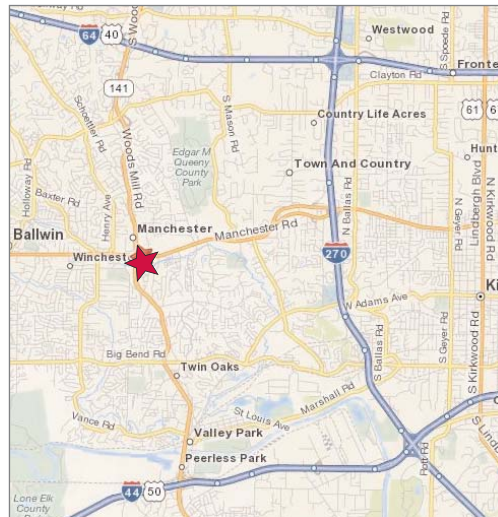

Property Highlights

- 51,696 SF retail / warehouse building on 4.85 acres
- 8,000 SF showroom / office; 32,000 SF sales; 10,000 SF warehouse
- 6 docks & 2 drive-ins; 14'-18' ceiling height; 39'x35' column spacing; Fully sprinklered
- Owner will vacate or lease back 20,000 SF for 5-10 year term

New Sale Price

~~\$2,750,000~~ **\$2,295,000**

* Confidential Sale - Please do not inquire with employees

Contact

Terry O'Connell
 314 994 4800
 toconnell@naidesco.com

Dan Hayes
 314 994 4068 Direct
 314 401 4944 Mobile
 dhayes@naidesco.com

NAIDESCO
 Commercial Real Estate Services, Worldwide.

The information contained herein has been given to us by the owner of the property or other sources we deem reliable. We have no reason to doubt its accuracy, but we do not guarantee it. All information should be verified prior to lease or purchase.

8235 Forsyth Blvd Ste 210 St Louis MO 63105
 Phone 314 994 4444 Fax 314 994 4088
 www.naidesco.com

FLOOR PLAN

14290 Manchester Rd, Manchester MO 63011

Warehouse
Not to Scale

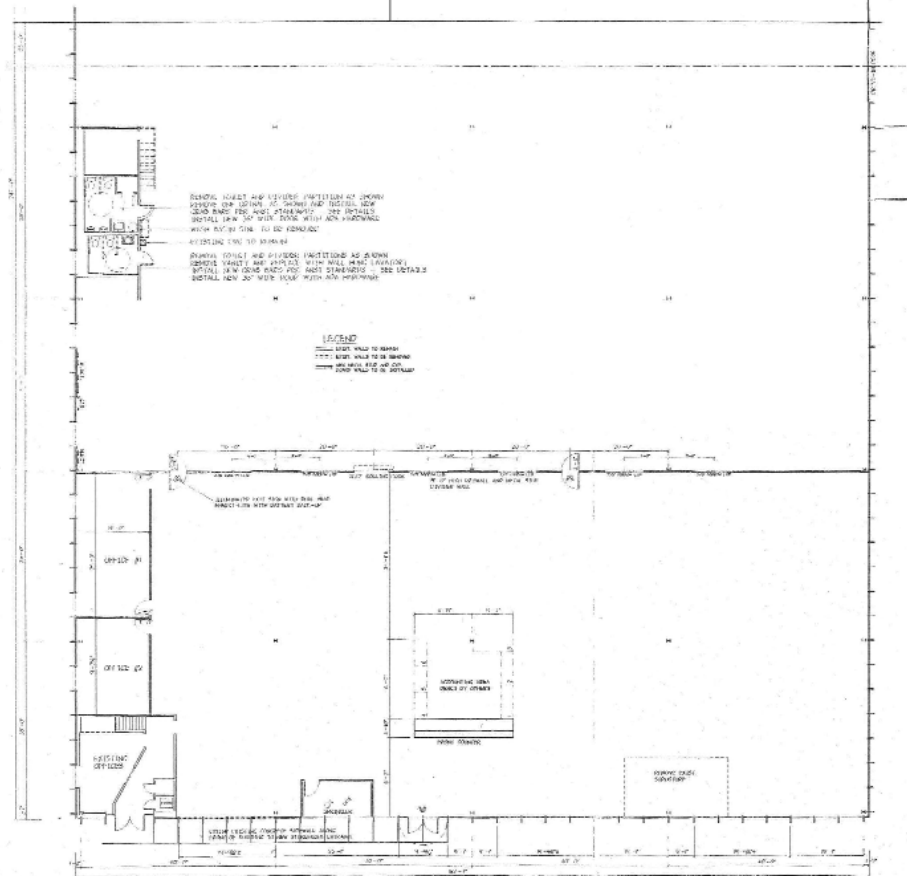

Contact



Commercial Real Estate Services, Worldwide.

Terry O'Connell
314 994 4800
toconnell@naidesco.com

Dan Hayes
314 994 4068 Direct
314 401 4944 Mobile
dhayes@naidesco.com

The information contained herein has been given to us by the owner of the property or other sources we deem reliable. We have no reason to doubt its accuracy, but we do not guarantee it. All information should be verified prior to lease or purchase.

8235 Forsyth Blvd Ste 210 St Louis MO 63105
Phone 314 994 4444 Fax 314 994 4088
www.naidesco.com